

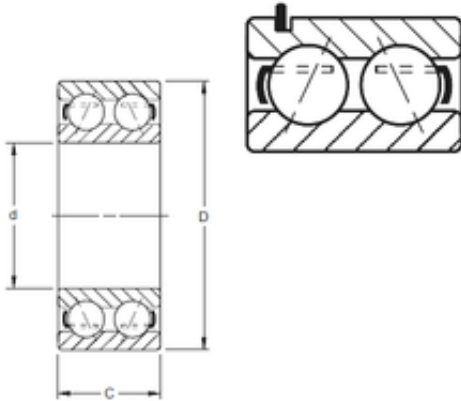

TIMKEN AXLE CORP.

TIMKEN 5309WG Angular Contact Ball Bearings

Bearing No. 5309WG



5309WG Bearing 2D drawings and 3D CAD models

Size	45x100x39.67 mm
Bore Diameter	45 mm
Outer Diameter	100 mm
Width	39,67 mm
d	45 mm
D	100 mm
C	39,67 mm
Angle ()	30 °
Weight	1,461 Kg
Basic dynamic load rating (C)	106 kN