

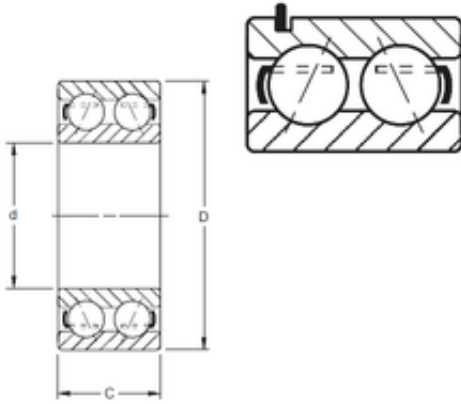

TIMKEN AXLE CORP.

TIMKEN 5310WG Angular Contact Ball Bearings

Bearing No. 5310WG



5310WG Bearing 2D drawings and 3D CAD models

Size	50x110x44.45 mm
Bore Diameter	50 mm
Outer Diameter	110 mm
Width	44,45 mm
d	50 mm
D	110 mm
C	44,45 mm
Angle ()	30 °
Weight	1,932 Kg
Basic dynamic load rating (C)	126 kN