

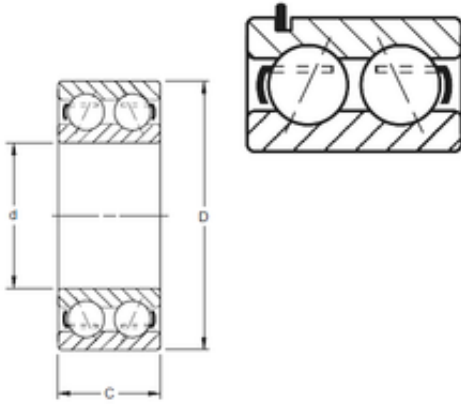

TIMKEN AXLE CORP.

TIMKEN 5311KG Angular Contact Ball Bearings

Bearing No. 5311KG



5311KG Bearing 2D drawings and 3D CAD models

Size	55x120x49.22 mm
Bore Diameter	55 mm
Outer Diameter	120 mm
Width	49,22 mm
d	55 mm
D	120 mm
C	49,22 mm
Angle ()	30 °
Weight	2,789 Kg
Basic dynamic load rating (C)	144 kN