

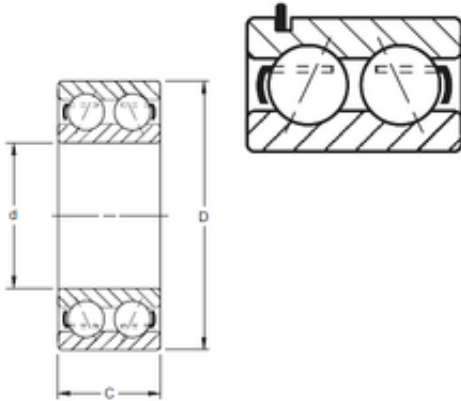

# TIMKEN AXLE CORP.

## TIMKEN 5305KG Angular Contact Ball Bearings

Bearing No. 5305KG



5305KG Bearing 2D drawings and 3D CAD models

|                               |               |
|-------------------------------|---------------|
| Size                          | 25x62x25.4 mm |
| Bore Diameter                 | 25 mm         |
| Outer Diameter                | 62 mm         |
| Width                         | 25,4 mm       |
| d                             | 25 mm         |
| D                             | 62 mm         |
| C                             | 25,4 mm       |
| Angle ( )                     | 20 °          |
| Weight                        | 0,376 Kg      |
| Basic dynamic load rating (C) | 37,7 kN       |