

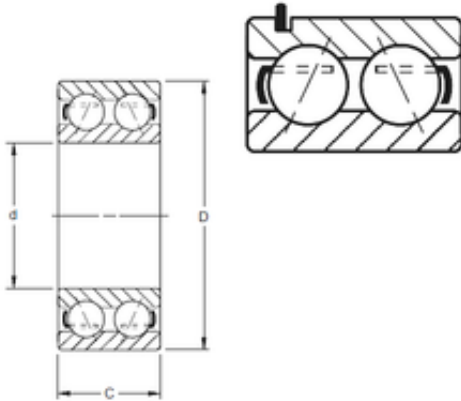

# TIMKEN AXLE CORP.

## TIMKEN 5306WG Angular Contact Ball Bearings

Bearing No. 5306WG



5306WG Bearing 2D drawings and 3D CAD models

Size	30x72x30.17 mm
Bore Diameter	30 mm
Outer Diameter	72 mm
Width	30,17 mm
d	30 mm
D	72 mm
C	30,17 mm
Angle ( )	30 °
Weight	0,608 Kg
Basic dynamic load rating (C)	62 kN