

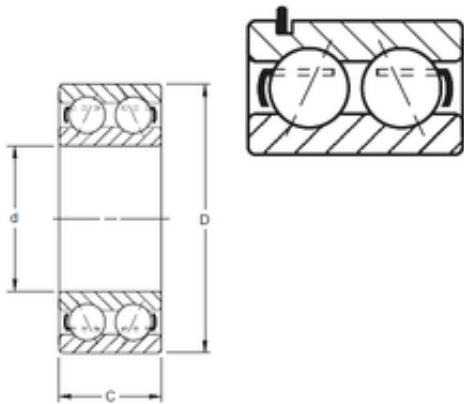

TIMKEN AXLE CORP.

50 mm x 90 mm x 30,17 mm TIMKEN 5210KG Angular Contact Ball Bearings



Bearing No. 5210KG

Size	50x90x30.17 mm
Bore Diameter	50 mm
Outer Diameter	90 mm
Width	30,17 mm
d	50 mm
D	90 mm
B	30,17 mm
C	30,17 mm
Angle (°)	20 °
Weight	0,771 Kg
Basic dynamic load rating (C)	66,6 kN

5210KG Bearing 2D drawings and 3D CAD models